

7.5kg Top Loading Washing Machine - User Manual

Model: CK8575



To avoid risk of accidents or damage to the appliance, it is essential to read these instructions before it is installed and used for the first time.

A+++

62db

185
kWh/ annum

Caterkwik Ltd

The Lakeland Catering Centre
Newlands
Ulverston
Cumbria
LA12 7QQ

01229 480001

info@caterkwik.co.uk



Contents

Safety Instructions

■ Safety Instructions	2
-----------------------------	---

Installation

■ Product Description	7
■ Installation	8

Operations

■ Quick Start	11
■ Before Each Wash	12
■ Detergent Dispenser	13
■ Control Panel	14
■ Options.....	17
■ Other Functions	19
■ Programmes	21
■ Washing Programmes Table	22

Maintenance

■ Cleaning And Care	25
■ Trouble Shooting	28
■ Technical Specification	29
■ Product Specification	30

Safety Instructions

■ Safety Instructions

For your safety, the information in this manual must be followed to minimise the risk of fire or explosion, electric shock, or to prevent property damage, personal injury or loss of life.

Explanation of the symbols:

Warning!

This indicates a potentially dangerous situation which may result in death or serious injuries unless avoided.

Caution!

This indicates a potentially dangerous situation which may result in slight or minor injuries or damage to property and the environment.

Note!

This indicates a potentially dangerous situation which may result in slight or minor injuries.

Warning!

Danger of Electric Shock!

- If the supply cord is damaged, it must be replaced by the manufacturer, a service agent or similarly qualified persons in order to avoid a hazard.

Safety Instructions

- The new hose-sets supplied with the appliance are to be used, old hose-sets should not be reused.
- Before any maintenance to the device, unplug the appliance from the mains.
- Always unplug the machine and turn off the water supply after use.
- To ensure your safety, the power plug must be inserted into an earthed three-pole socket. Check carefully and make sure that your socket is properly and reliably earthed.
- Water and electrical devices must be connected by a qualified technician in accordance with the manufacturer's instructions and local safety regulations.

Not be used by children!

- The appliance can not be used by children and persons with reduced physical, sensory or mental capabilities or lack of experience and knowledge. Children shall not play with the appliance. Cleaning and user maintenance shall not be done by children.
- Animals and children may climb into the machine. Check the machine before every operation.

Safety Instructions

- **Remove all packages and transport bolts before using the appliance. Otherwise, serious damage may result.**
- The plug must be accessible after installation.

Risk of explosion!

- Do not wash or dry articles that have been cleaned in, washed in, soaked in, or dabbed with combustible or explosive substances (such as wax, oil, paint, gasoline, degreasers, dry-cleaning solvents, kerosene, etc.) This may result in fire or explosion.

⚠ Caution!

Installing the product

- This washing machine is for indoor use only.
- It is not intended to be built-in.
- The openings must not be obstructed.
- The washing machine shall not be installed in the bath room or very wet rooms as well as in the rooms with explosive or caustic gases.
- The washing machine has a single inlet valve and must be connected to a **cold water supply**.
- Ensure the plug is accessible after installation.

Safety Instruction!

Risk of damaging appliance!

- This product is only for home use and is only designed for the textiles suitable for machine washing.
- Do not sit on top of the washing machine.
- Do not lean against machine door.
- Cautions when moving the washing machine:
 1. Transport bolts should be reinstalled to the machine by a competent person.
 2. The accumulated water shall be drained out of the machine.
 3. Handle the machine carefully. Never hold each protruded part on the machine while lifting. Machine door can not be used as a handle during the conveyance.
 4. This appliance is heavy. Transport with care.
- Please do not close the door with excessive forces. If it is found difficult to close the door, please check if the clothes are not trapped and are evenly distributed.
- It is not suitable for washing carpets.

Operating the appliance

- Before using the machine for the first time, you should complete a wash without clothes.
- Do not use flammable and explosive or toxic solvents. Gasoline and alcohol etc. Shall not be used as detergents. Please only use the detergents suitable for machine washing.

Safety Instruction!

- Make sure that all pockets are emptied. Sharp and rigid items such as coins, nails, screws or stones etc. may cause serious damage to this machine.
- Please check whether the water inside the drum has been drained before opening its door. Please do not open the door if there is any water visible.
- Be careful of scalding when the product drains hot washing water.
- Never refill the water by hand during washing.
- After the program is completed, Please wait for two minutes before opening the door.

Safe Disposal



This marking indicates that this product should not be disposed with other household wastes throughout the EU. To prevent possible harm to the environment or human health from uncontrolled waste disposal, recycle it responsibly to promote the sustainable reuse of material resources. To return your used device, please use the collection systems or contact the retailer where the product was purchased. They return and can take this product for environmental safe recycling.

Installation

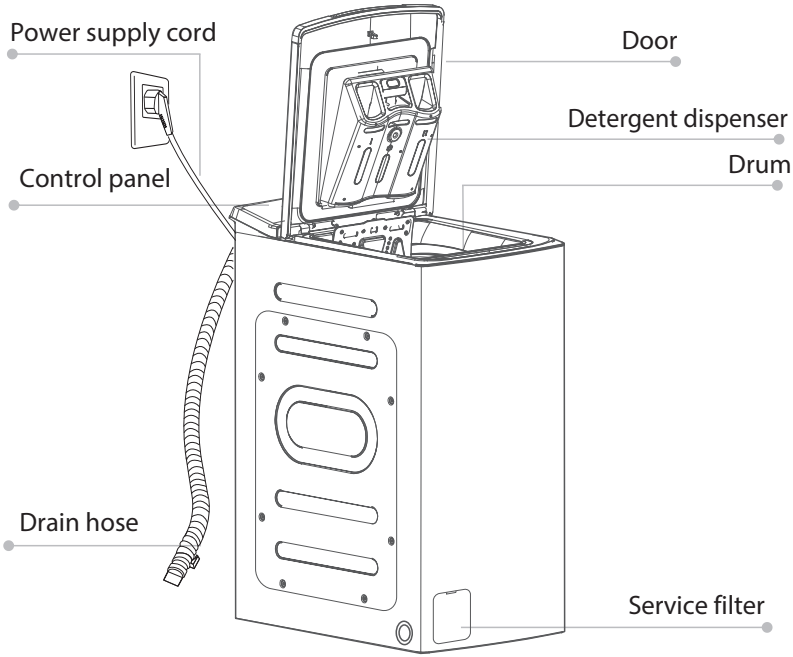

Note!

- The product line chart is for reference only.

Accessories

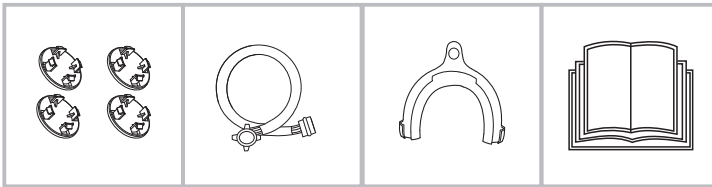

Transport hole plug

cold water supply hose

Drain hose support

Owner's manual

Installation

■ Installation

Installation area

⚠ Warning!

- Stability is important to prevent the product from wandering!
- Make sure that the product does not stand on the power cord.

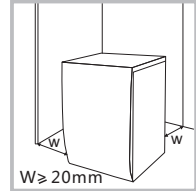

The installation should be:

1. Rigid, dry, and level surface
2. Avoid direct sunlight
3. Offer sufficient ventilation
4. Have an ambient temperature of above 0°C.
5. Be located away from the heat sources.

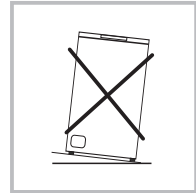

Unpacking the washing machine

⚠ Warning!

- Packaging material (e.g. Films, Styrofoam) can be dangerous for children.
- There is a risk of suffocation! Keep all packaging well away from children.

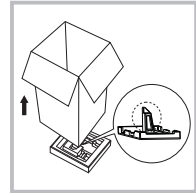

1. Remove the cardboard box and styrofoam packing.
2. Lift the washing machine and remove the base packing. Make sure foam is removed with the bottom. If not, lay the unit down, then remove the small foam from bottom of the unit manually.
3. Remove the tape securing the power supply cord and drain hose.
4. Remove the inlet hose from the drum.

Remove transport bolts!

⚠ Warning!

- You must remove the transport bolts from the rearside before using the product. You will need the transport bolts again if you move the product, so make sure you keep them in a safe place.

Please take the following steps to remove the bolts:

1. Loosen 4 bolts with spanner and then remove them.
2. Stop the holes with transport hole plugs.
3. Keep the transport bolts in a safe place for future use.

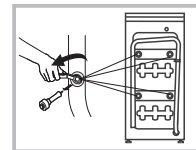

Installation

Levelling the washing machine

⚠ Warning!

- The lock nuts on all four feet must be screwed tightly against the housing.

1. Check that the legs are closely attached to the cabinet. If not, please turn them to their original position and tighten the nuts.
2. Loosen the lock nut turn the feet until it closely contacts with the floor.
3. Adjust the legs and lock them with a spanner, make sure the machine is steady.

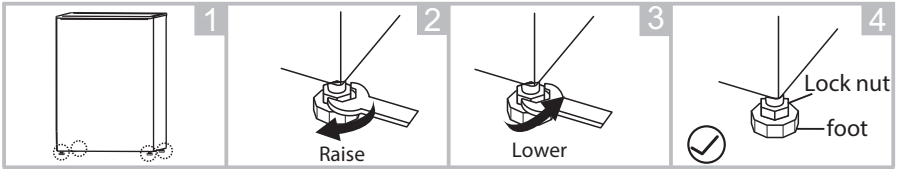

Connect Water Supply Hose

⚠ Warning!

- Do not kink, crush, modify or sever water inlet hose.
- Connect with cold water inlet hose.

Connect the inlet pipe as indicated. There are two ways to connect the inlet pipe. 1. Connection between ordinary tap and inlet hose.

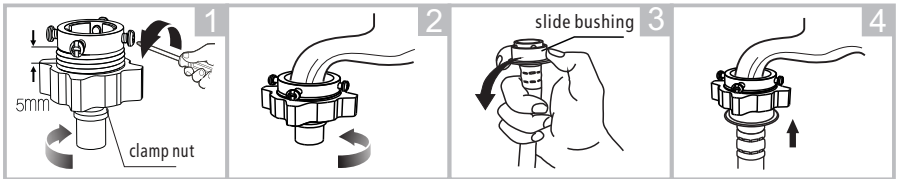

Loosen clamp nut and four bolts

Tighten clamp nut

Press slide bushing, insert inlet hose into connecting base

Connection finished

2. Connection between screw tap and inlet hose.

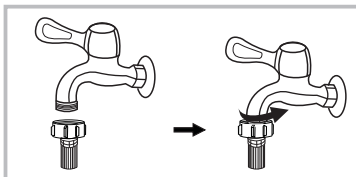

Tap with threads and inlet hose

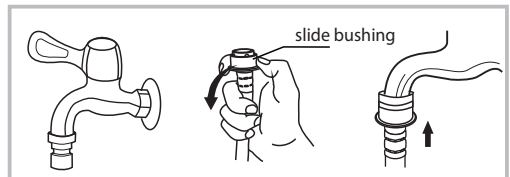

Special tap for washing machine

Installation

Connect the other end of inlet pipe to the inlet valve at the rearside of product and fasten the pipe tightly clockwise.

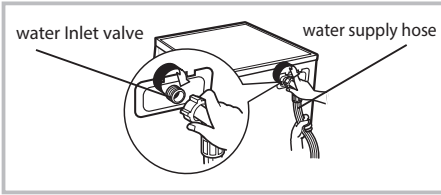

Drain Hose

⚠ Warning

- Do not kink or protract the drain hose.
- Position drain hose properly to prevent leaking.

There are two ways to place the end of drain hose:

1. Put it into the water trough.

2. Connect it to the branch drain pipe of the trough.

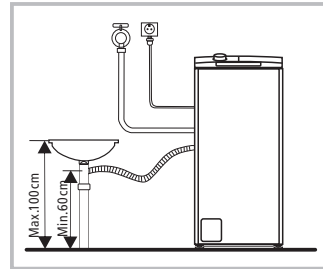
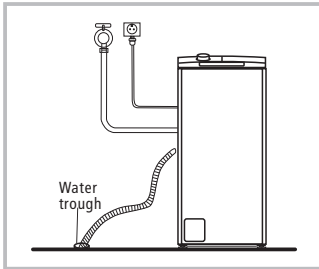

📌 Note!

- If the machine has drain hose support, please install it like the following.

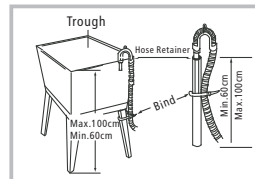
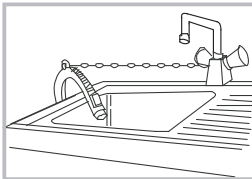

⚠ Warning!

- When installing the drain hose, fix it properly.
If drain hose is too long, do not force it into washing machine as it will cause damage to the machine.

Operation

■ Quick Start

⚠ Caution!

- Before washing, please make sure it is installed properly.
Before washing for the first time, complete a wash cycle without clothes.

1. Before Washing

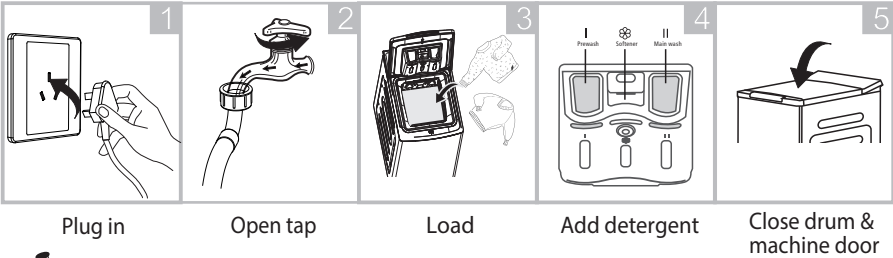

📌 Note!

- Detergent need to be added in "case 1 "after selecting pre-washing.

2. Washing

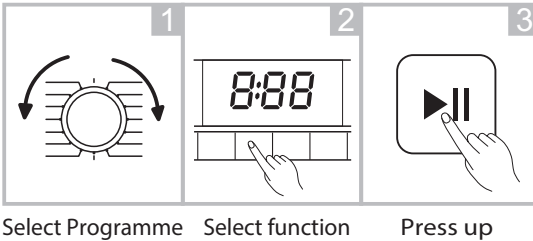

📌 Note!

- If default is selected, step 2 can be skipped.

3. After Washing

"End" is displayed.

Operation

■ Before Each Wash

- The ambient temperature should be (0-40)°C. If used under 0°C, the inlet valve and draining system may be damaged. If the machine is placed under condition of 0°C or less, then it should be transferred to normal ambient temperature to ensure the water supply hose and drain hose are not frozen before use.
- Please check the clothing labels and the detergent instructions prior to washing. Use non-foaming or less-foaming detergent suitable for washing machines.

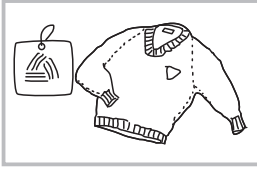

Check the label

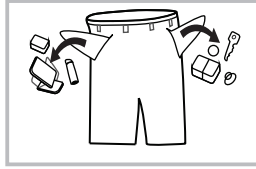

Take out the items out of the pockets

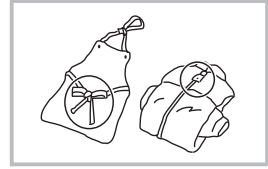

Knot the long strips, zips and button

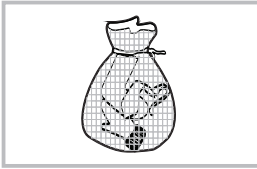

Put small clothes into a wash bag

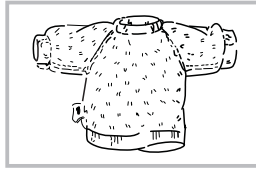

Turn easy-pilling and long-pile fabric inside out

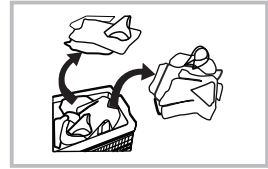

Separate clothes with different textures

⚠ Warning!

- When washing a single item, it may cause an 'unbalanced' alarm. Therefore it is suggested to add more clothes to be washed together so that draining can be done smoothly.
- Don't wash clothes contaminated with kerosene, gasoline, alcohol and other flammable materials.

Operation

■ Detergent Dispenser

- I Pre wash detergent
- II Main wash detergent
- ☼ Softener

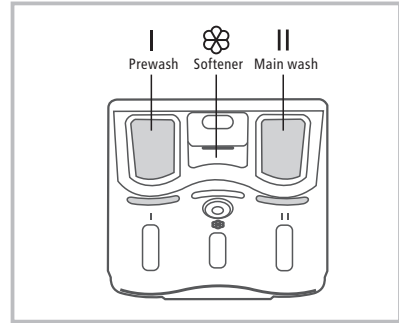

Pull out the dispenser

⚠ Caution!

- Detergent only needs to be added in "case I" after selecting pre-washing for machines with this function.

Programme	I	II	☼	Programme	I	II	☼
Cotton	○	●	○	Spin Only			
Synthetic	○	●	○	Rinse & Spin			○
Mix	○	●	○	Wool		●	○
Jeans	○	●	○	Delicate		●	○
Sportswear	○	●	○	Daily Wash 45'	○	●	○
Colour Care		●	○	Quick 15'		●	○
Baby Care	○	●	○	Cotton ECO		●	○
Drum Clean							

● Not Optional ○ Optional

📌 Note!

- Do not use congealed detergent as it could cause the inlet of detergent box to be blocked and overflow while filling water.
- Please choose suitable type of detergent for the various washing temperature to achieve the best washing performance with less water and energy consumption.

Operation

■ Control Panel

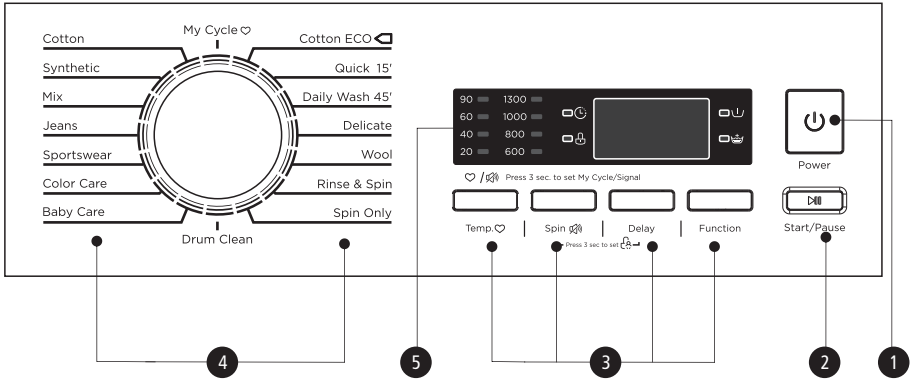

Note!

- The chart is for reference only, actual product may vary.

- 1 On/Off**
Product is switched On/Off.
- 2 Start/Pause**
Press the button to start or pause the washing cycle.
- 3 Option**
This allows you to select an additional function and will light
- 4 Programmes**
Available according to the laundry type.
- 5 Display**
The display shows the settings, estimated time remaining, options, and status messages for your machine. The display will remain on through the cycle.

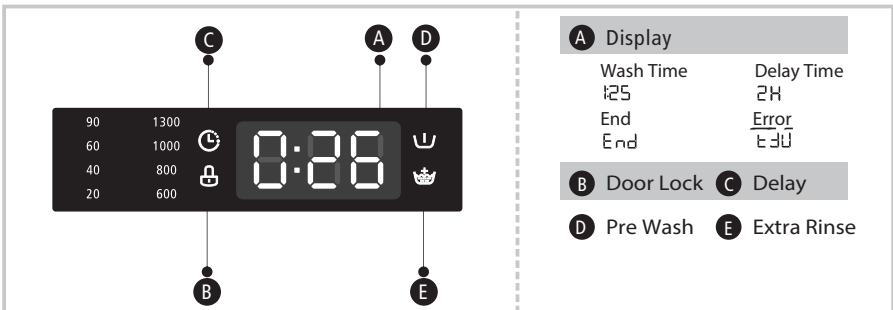

Operation

■ Control Panel

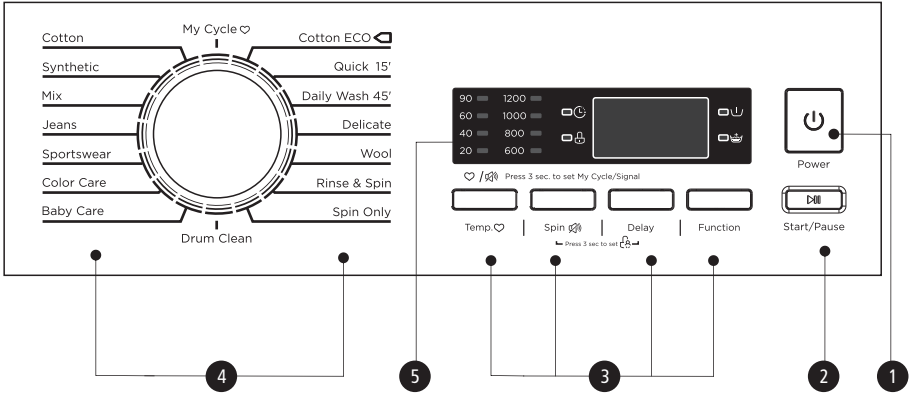

Note!

- The chart is for reference only, Please refer to real product as standard.

- | | |
|---|---|
| <p>1 On/Off
Product is switched On/Off.</p> | <p>2 Start/Pause
Press the button to start or pause the washing cycle.</p> |
| <p>3 Option
This allows you to select an additional function and will light</p> | <p>4 Programmes
Available according to the laundry type.</p> |
| <p>5 Display
The display shows the settings, estimated time remaining, options, and status messages for your washer. The display will remain on through the cycle.</p> | |

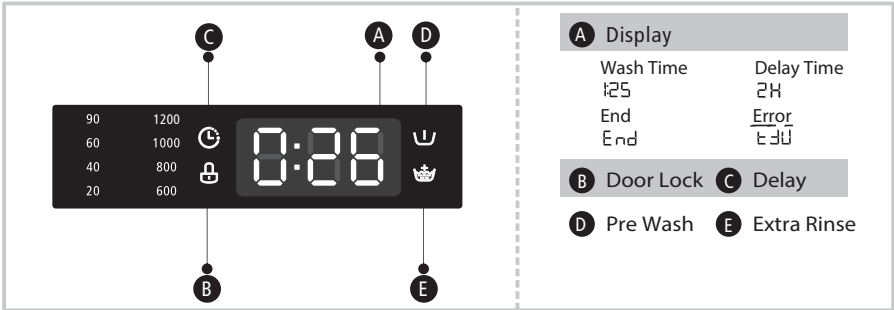

Operations

Control Panel

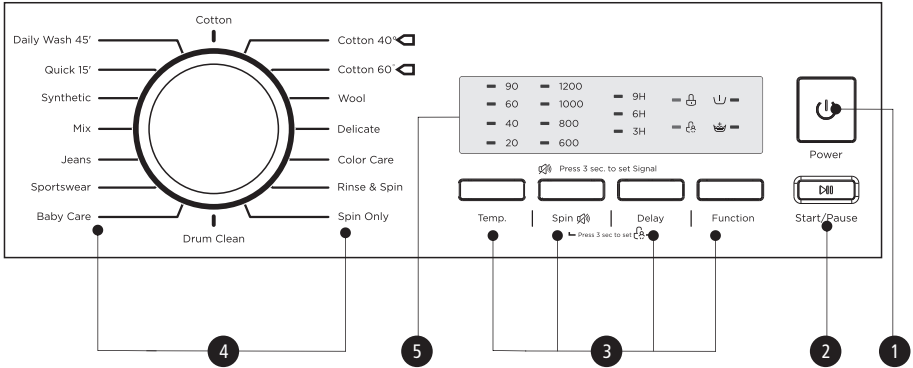

Note!

- The chart is for reference only, Please refer to real product as standard.

- On/Off**
Product is switched On/Off.
- Start/Pause**
Press the button to start or pause the washing cycle.
- Option**
This allows you to select an additional function and will light when selected.
- Programmes**
Available according to the laundry type.
- Display**
The display shows the settings, options for your washer. The display will remain on through the cycle.

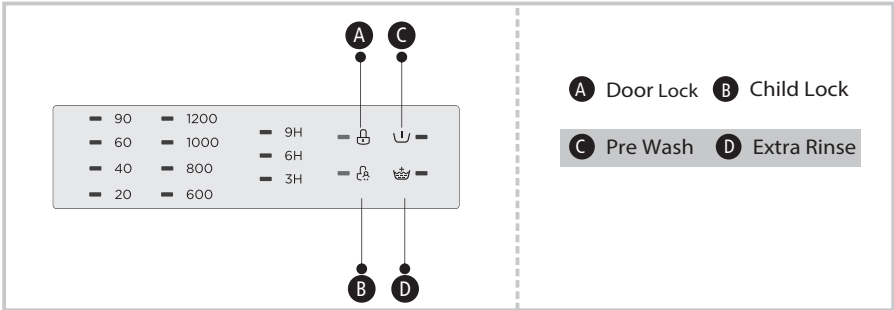

Operation

■ Option

Pre-Wash

Pre Wash

The Pre-wash function offers an extra wash before the main wash. It is suitable for heavily soiled garments; You need to put detergent into the Case (I) when you select it.

Extra Rinse

Extra Rinse

The laundry will undergo an extra rinse when selected.

Delay

Delay

Set the Delay function:

1. Select a programme; 2.Press the Delay button to choose the time (the delay options are: 0-24 H/3H-6H-9H);
- 3.Press [Start/Pause] to commence the delay operation



Choose the Programme Setting time Start

Cancel the Delay function:

Press the [Delay] button until the display be 0H.It should be pressed before starting the programme. If the programme has already started, switch off programme to reset.

⚠ Caution!

- If there is any break in the power supply while the machine is operating, a special memory stores the selected programme and when the power is restarted, the program will continue.

Programme	Option			Programme	Option		
	Delay	Extra rinse	Pre wash		Delay	Extra rinse	Pre wash
Cotton	<input type="radio"/>	<input type="radio"/>	<input type="radio"/>	Drum Clean	<input type="radio"/>		
Daily Wash 45'	<input type="radio"/>	<input type="radio"/>	<input type="radio"/>	Spin Only	<input type="radio"/>		
Quick 15'	<input type="radio"/>			Rinse & Spin	<input type="radio"/>	<input type="radio"/>	
Synthetic	<input type="radio"/>	<input type="radio"/>	<input type="radio"/>	Colour Care	<input type="radio"/>	<input type="radio"/>	
Mix	<input type="radio"/>	<input type="radio"/>	<input type="radio"/>	Delicate	<input type="radio"/>	<input type="radio"/>	
Jeans	<input type="radio"/>	<input type="radio"/>	<input type="radio"/>	Wool	<input type="radio"/>	<input type="radio"/>	
Sportswear	<input type="radio"/>	<input type="radio"/>	<input type="radio"/>	Cotton 60	<input type="radio"/>	<input type="radio"/>	<input type="radio"/>
Baby Care	<input type="radio"/>	<input type="radio"/>	<input type="radio"/>	Cotton 40	<input type="radio"/>	<input type="radio"/>	<input type="radio"/>

Means optional

Operations

Programme	Option			Programme	Option		
	Delay	Extra rinse	Pre wash		Delay	Extra rinse	Pre wash
Cotton	<input type="radio"/>	<input type="radio"/>	<input type="radio"/>	Spin Only	<input type="radio"/>		
Synthetic	<input type="radio"/>	<input type="radio"/>	<input type="radio"/>	Rinse & Spin	<input type="radio"/>	<input type="radio"/>	
Mix	<input type="radio"/>	<input type="radio"/>	<input type="radio"/>	Wool	<input type="radio"/>	<input type="radio"/>	
Jeans	<input type="radio"/>	<input type="radio"/>	<input type="radio"/>	Delicate	<input type="radio"/>	<input type="radio"/>	
Sportswear	<input type="radio"/>	<input type="radio"/>	<input type="radio"/>	Daily Wash 45'	<input type="radio"/>	<input type="radio"/>	<input type="radio"/>
Colour Care	<input type="radio"/>	<input type="radio"/>		Quick 15'	<input type="radio"/>		
Baby Care	<input type="radio"/>	<input type="radio"/>	<input type="radio"/>	Cotton ECO	<input type="radio"/>		
Drum Clean	<input type="radio"/>						

Means optional

Operation

Other Functions

Temp.

Temp.

Press the button to regulate the temperature(Cold,20°C, 40°C,60°C,90°C)

Spin

Spin

Press the button to change the

speed. 1200: 0-600-800-1000-1200 1300: 0-600-800-1000-1300

Programme	Default Speed (rpm)	Programme	Default Speed (rpm)
	1200		1200
Cotton	1200	Drum Clean	–
Daily Wash 45'	800	Spin Only	800
Quick 15'	800	Rinse & Spin	800
Synthetic	1200	Colour Care	1000
Mix	800	Delicate	600
Jeans	800	Wool	600
Sportswear	800	Cotton 60	800
Baby Care	800	Cotton 40	800

Programme	Default Speed (rpm)		Programme	Default Speed (rpm)	
	1200	1300		1200	1300
Cotton	1200	1300	Spin Only	800	1000
Synthetic	1200	1300	Rinse & Spin	800	1000
Mix	800	1000	Wool	600	600
Jeans	800	800	Delicate	600	600
Sportswear	800	800	Daily Wash 45'	800	800
Colour Care	1000	1000	Quick 15'	800	800
Baby Care	800	800	Cotton ECO	800	800
Drum Clean	–	–			

Operation



Child Lock

To prevent operation by children.



Choose the Programme

Start

Press [Spin] and [Delay]
3 sec. until buzzer beep.

⚠ Caution!

- When the "Child Lock" function is activated, the buzzer will beep 3 times.
- Press the two buttons for 3 seconds also to release the function.
- The "Child Lock" will lock all buttons except Power button.



Mute the buzzer



Choose the Programme

Press the [Spin]button for 3sec.,
the buzzer is mute.

To re-activate the buzzer function, press the button again
for 3 seconds. The setting will be kept until the next reset.



My Cycle

To memorise your frequently used programme.

After choosing the programme and setting the options, press [Temp.] for 3
seconds. before starting the wash.

Operation

■ Programmes

Programmes are available according to the laundry type.

Programmes	
Cotton	Hard-wearing textiles, heat-resistant textiles made of cotton or linen.
Synthetic	Wash synthetic articles, for example: shirts, coats. When washing knitted textiles, detergent quantity should be reduced due to its propensity to form bubbles.
Baby Care	Extra clean and extra rinse to protect babies skin.
Daily Wash 45'	Washing few and not very dirty clothes quickly.
Mix	Mixed load consisting of textiles made of cotton and synthetics.
Sportswear	Washing activewear.
Jeans	Specially for jeans.
Quick 15'	Extra short programme, suitable for lightly soiled small amounts of laundry.
Delicate	For delicate, washable textiles, e.g. silk, satin, synthetic fibres or blended fabrics.
Wool	Machine-washable wool or rich wool textiles. An exceptionally gentle wash programme to prevent shrinkage. Includes longer programme pauses (textiles rest in wash liquid).
Spin Only	Extra spin with selectable spin speed.
Rinse & Spin	Extra rinse with spin.
Cotton ECO	Washing time is increased. Economy setting.
Drum Clean	Specially set in this machine to clean the drum and tubes. It applies 90 °C high temperature clean. When this programme is performed, the clothes or other washing cannot be added. When proper amount of chlorine bleaching agent is put in, the barrel cleaning effect will be better. You can use this programme regularly according to the need.
Colour Care	Washing brightly coloured clothes protects the colours.

Operation

■ Washing Programmes Table

Programme	Load (kg)	Temp. (°C)	Default Time
Cotton	6.5	40	2:40
Daily Wash 45'	2.5	40	0:45
Quick 15'	2.0	Cold	0:15
Synthetic	3.25	40	2:20
Mix	6.5	40	1:13
Jeans	6.5	60	1:45
Sportswear	3.25	40	1:31
Baby Care	6.5	40	1:27
Drum Clean	–	90	1:18
Spin Only	6.5	–	0:12
Rinse & Spin	6.5	–	0:20
Colour Care	3.25	Cold	1:10
Delicate	2.0	20	0:49
Wool	2.0	40	1:07
Cotton 60	6.5	60	2:45
Cotton 40	6.5	40	2:40

- The EU energy efficiency class is: A+++
Energy test program: Cotton 60/40°C.
Speed: the highest speed; as the default.
Half load for 6.5Kg machine:3.25Kg.
- “Cotton 60/40°C” is the standard washing programs to which the information in the label relates, suitable to clean normally soiled cotton laundry and they are the most efficient programmes in terms of combined energy and water consumptions for washing that type of cotton laundry, that the actual water temperature may differ from the declared cycle temperature.

Note!

- The parameters in this table are only for user's reference. The actual parameters may be different from the parameters in above table.

Operation

■ Washing Programmes Table

Programme	Load (kg)	Temp.(°C)	Default Time
Cotton	7.5	40	2:40
Synthetic	3.75	40	2:20
Mix	7.5	40	1:13
Jeans	7.5	60	1:45
Sportswear	3.75	40	1:31
Colour Care	3.75	Cold	1:10
Baby Care	7.5	40	1:27
Drum Clean	-	90	1:18
Spin Only	7.5	-	0:12
Rinse & Spin	7.5	-	0:20
Wool	2.0	40	1:07
Delicate	2.0	20	0:49
Daily Wash 45'	2.5	40	0:45
Quick 15'	2.0	Cold	0:15
Cotton ECO	7.5	20	0:55

- The EU energy efficiency class is: A+++
Energy test program: Cotton ECO.

Speed: the highest speed; Temp.:60/40°C ; Other as the default.

Half load for 7.5Kg machine:3.75Kg.

- "Cotton ECO 60/40°C " is the standard washing programs to which the information in the label and the fiche relates, and they are suitable to clean normally soiled cotton laundry and that they are the most efficient programmes in terms of combined energy and water consumptions for washing that type of cotton laundry, that the actual water temperature may differ from the declared cycle temperature.

Note!

- The parameters in this table are only for user's reference. The actual parameters may be different from the parameters in above table.

Operation

■ Washing Programmes Table

Programme	Load (kg)	Temp. (°C)	Default Time
Cotton	8.0	40	2:40
Synthetic	4.0	40	2:20
Mix	8.0	40	1:13
Jeans	8.0	60	1:45
Sportswear	4.0	40	1:31
Colour Care	4.0	Cold	1:10
Baby Care	8.0	40	1:27
Drum Clean	-	90	1:18
Spin Only	8.0	-	0:12
Rinse & Spin	8.0	-	0:20
Wool	2.0	40	1:07
Delicate	2.0	20	0:49
Daily Wash 45'	2.5	40	0:45
Quick 15'	2.0	Cold	0:15
Cotton ECO	8.0	20	0:55

- The EU energy efficiency class is: A++
+-30%Energy test program: Cotton ECO
Speed: the highest speed;Temp.:60/40°C ; Other as the default.
Half load for8.0Kg machine:4.0Kg.
- "Cotton ECO 60/40°C " is the standard washing programs to which the information in the label and the fiche relates, and they are suitable to clean normally soiled cotton laundry and that they are the most efficient programmes in terms of combined energy and water consumptions for washing that type of cotton laundry, that the actual water temperature may differ from the declared cycle temperature.

Note!

- The parameters in this table are only for user's reference. The actual parameters may be different from the parameters in above table.

Maintenance

■ Cleaning And Care

Warning!

- Before any maintenance, please unplug the machine and isolate the water. .

Cleaning The Cabinet

Proper maintenance on the washing machine can extend its working life. The surface can be cleaned with diluted non-abrasive neutral detergents when necessary. If there is any water overflow, use the wet cloth to wipe it off immediately.

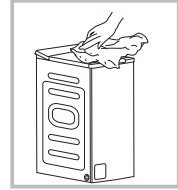

Note!

- Do not use formic acid and its diluted solvents or equivalent, such as alcohol, solvents or chemical products, etc.

Cleaning The Drum

Clean with chlorine-free detergents. Never use steel wool.

Note!

- Do not put laundry in the washing machine during the drum clean cycle.

Maintenance

Cleaning The Inlet Filter

Note!

- The inlet filter must be checked and cleaned regularly.

Washing the filter in the tap

1. Isolate the water supply.
2. Remove the water supply hose from the tap.
3. Clean the filter.
4. Reconnect the water supply hose.

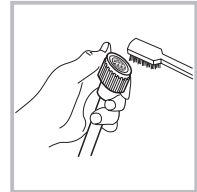
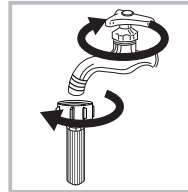

Washing the filter in washing machine:

1. Unscrew the inlet pipe from the backside of the machine.
2. Pull out the filter with long nose pliers and reinstall it back after being washed.
3. Use the brush to clean the filter.
4. Reconnect the inlet pipe.

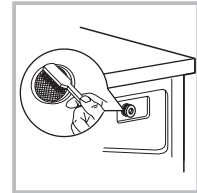
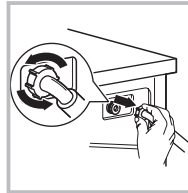

Note!

- Reconnect, turn on the tap.

;

Clean The Detergent Dispenser

1. Press down on the arrow located on softener cover inside the dispenser drawer.
2. Lift the clip up and take out softener cover and wash all grooves with water.
3. Restore the softener cover and push the drawer into position.

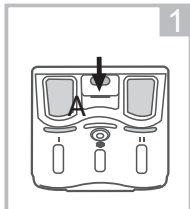

Pull out the dispenser drawer press 'A'



Clean the dispenser drawer.

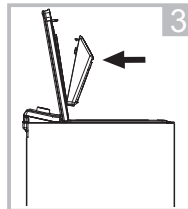

Insert the dispenser drawer

Note!

- Do not use alcohol, solvents or chemical products to clean the machine.

Maintenance

Cleaning The Drain Pump Filter

⚠ Warning!

- Be careful of the hot water!
 - Allow detergent solution to cool down.
- Unplug the machine to avoid electrical shock before washing.
- Drain pump filter can filter the yarns and small foreign matters from the washing.
- Clean the filter periodically to ensure the normal operation of washing machine.

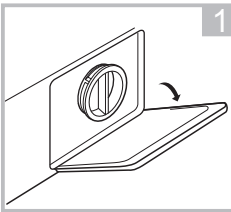

Open the lower cover cap

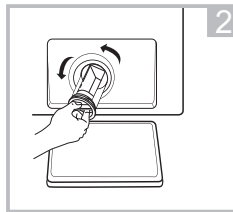

Open the filter by turning to the counter clockwise

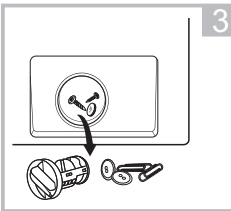

Remove extraneous matter

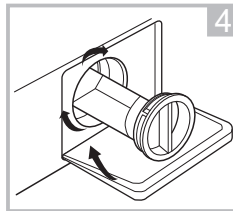

Close the lower cover cap

⚠ Caution!

- Make sure that valve cap and emergency drain hose are reinstalled properly, cap plates should be inserted aligning to hole plates otherwise water may leak.
- When the appliance is in use and depending on the programme selected there can be hot water in the pump. Never remove the pump cover during a wash cycle, always wait until the appliance has finished the cycle, and is empty. When replacing the cover, ensure it is securely re-tightened.

Maintenance

■ Trouble Shooting

The appliance does not start or it stops during operation. First try to find a solution to the problem, If not, contact our service team on 01229 480001.

Description	Reason	Solution
Washing machine will not start up	Door is not closed properly	Restart after the door is closed check if the clothes are stuck
Door can't be opened	Washer's safety protection design is working	Disconnect the power, restart the machine
Water leakage	The connection between inlet pipe or outlet hose is not tight	Check and fasten water pipes. Clean outlet hose
Detergent residues in the box	Detergent is dampened or agglomerated	Clean and wipe the detergent box
Indicator or display does not light	Disconnect the power, PC board or harness has connection problem	Check if the power is shut down and the power plug is connected correctly
Abnormal noise		Check if the fixing (bolts) have been removed Check it's installed on a solid and level floor

Description	Reason	Solution
E30	Door is not closed properly	Restart after the door is closed check if the clothes is stuck
E10	Water injecting problem while washing	Check if the water pressure is too low Straighten the water pipe Check if the inlet valve filter is blocked
E21	Slow draining	Check if the drain hose is blocked
E12	Water overflow	Restart the washer
EXX	Others	Restart machine. If error persists please call our service team on 01229 480001.



Note!

- After the check, activate the appliance. If the problem occurs or the display shows other alarm codes again, contact the service.

Specification

■ Technical Specifications

Power Supply 220-240V~,50Hz

MAX.Current 10A

Standard Water Pressure 0.1MPa~1MPa

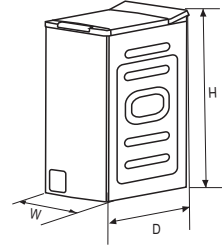

Model	Washing Capacity	Dimension (W*D*Hmm)	Net Weight	Rated Power
CK8575	7.5kg	400*610*875	56kg	2100W

Specification

■ Product Specification

Model	CK8575
Capacity	7.5kg
Spin Speed	1200 rpm
Energy efficiency class	① A +++
Annual energy consumption	② 185 kWh /annual
Power consumption of off - mode	0.5W
Power consumption of Left on -mode	1.0W
Annual water consumption	③ 11000L /annual
Spin- drying efficiency class	④ B
Standard washing cycle	⑤ Cotton
Energy consumption of the standard 60°C at full load	0.87 kwh /cycle
Energy consumption of the standard 60°C at partial load	0.80 kwh /cycle
Energy consumption of the standard 40° C at partial load	0.74 kwh /cycle
Programme duration of standard 60° C at full load	310 min
Programme duration of standard 60°C at partial load	290 min
Programme duration of standard 40°C at partial load	290 min
Water consumption of the standard 60° C at full load	52 L /cycle
Water consumption of standard 60°C at partial load	47 L /cycle
Water consumption of the standard 40° C at partial load	47 L /cycle
Remaining moisture content of the standard 60°C at full load	50%
Remaining moisture content of the standard 60°C at partial load	55%
Remaining moisture content of the standard 40°C at partial load	55%
Noise level of washing	62dB (A)
Noise level of spinning	78dB (A)

Maintenance

Note!

Programme setting for testing in accordance with applicable standard. When using the test programmes, wash the specified load using the maximum spin speed.

The actual parameters will depend on how the appliance is used, and maybe different with the parameters in above mentioned table.

The washing machine is equipped with power management system. The duration of the left-on mode time is less than 10 minute.

- The noise emissions during washing/spinning for the standard washing cycle at full load.

Remarks:

- 1 The energy efficiency class is from A (highest efficiency) to D (lowest efficiency)
- 2 Energy consumption per year, based on 220 standard washing cycles for standard programme at 60°C and 40°C at full and partial load, and the consumption of the low-power modes. Actual energy consumption will depend on how the appliance is used.
- 3 Water consumption per year based on 220 standard washing cycles for standard programme at 60°C and 40°C at full and partial load. Actual water consumption will depend on how the appliance is used.
- 4 Spin-drying efficiency class from G (least efficient) to A (most efficient).
- 5 The standard 60°C programme and the standard 40°C programme are the standard washing programmes. These programmes are suitable to clean normally soiled cotton laundry and they are the most efficient programmes in terms of combined energy and water consumptions for washing that type of cotton laundry. The actual water temperature may differ from the declared cycle temperature.
Please choose the suitable type of detergent for the various washing temperatures to get the best washing performance with less water and energy consumption.

7.5kg Top Loading Washing Machine - User Manual

Model: CK8575



To avoid risk of accidents or damage to the appliance, it is essential to read these instructions before it is installed and used for the first time.

A+++

62db

185
kWh/ annum

Caterkwik Ltd

The Lakeland Catering Centre
Newlands
Ulverston
Cumbria
LA12 7QQ

01229 480001

info@caterkwik.co.uk

